



STANDARD FLATSCREEN MONITOR ARMS

CHARACTERISTICS

	<p>Materials: Black ABS + metal</p> <p>Description: Flatscreen monitor arm with gas-spring mechanism. Two versions available: 1-screen and 2-screen.</p> <p>Maximum load & screen compatibility:</p> <ul style="list-style-type: none">- VESA bracket size: 100 x 100 mm and 75 x 75 mm- Max. load: 9 kg per arm/screen <p>Maximum recommended screen size: 17 to 32 inches</p> <p>Cable management: ABS clasps on the arm</p> <p>Fastening: Clamp mount (for worktops of thickness 10 to 85 mm) or grommet mount. Both types of mount are included.</p> <p>Adjustments: 4-point articulated arm. 3 pivot points: inclination of +70°/-45° + rotation 360° + pivot 90°.</p>
--	---

MONITOR ARMS - FASTENING ONTO RAIL

PROPERTIES

<div>ECONOMY</div> <div></div>	<p>Materials: Steel</p> <p>Maximum loads & compatible monitors: 2 articulations: L. 13 cm. Maximum load: 8 kg. 3 articulations: L. 24.5 cm. Maximum load: 6 kg.</p> <p>Maximum recommended monitor size: 27 inches - Universal VESA centre distance 75 or 100 mm.</p> <p>Fastening: Fastened onto the acoustic desktop screens LUCIEN.</p> <p>Adjustments: Support on 2 or 3 articulations (depending on model)</p>
---	--

TECHNICAL FILE

ECO FLATSCREEN MONITOR ARMS

PROPERTIES

<div>ECO</div> 	<div>Materials:</div> <p>Metal - ABS</p> <div>Description:</div> <p>Motor arm for simple fitting and design</p> <div>Maximum loads & compatible monitors:</div> <ul style="list-style-type: none"> - Clasp for VESA Standard monitor:100 x 100 mm and 75 x 75 mm - Max. load: 8 kg per arm/screen <div>Maximum recommended monitor size:</div> <p>from 10 to 32 inches - maximum 8 kg for each monitor.</p> <div>Cable management:</div> <p>ABS clasps on the arm</p> <div>Fastening:</div> <p>2 options: clamp mount (for worktops of thickness 10 to 88 mm) or grommet mount (through a hole or a Ø 80 mm cable port). Both types of mount are included.</p> <div>Adjustments:</div> <p>4-articulation holder. 3 pivot points: inclination of +45°/-45° - Rotation 360 ° and pivot 180°. Height-adjustable from 0 to 44 cm. Depth adjustable from 4 to 46 centimetres.</p>
---	--

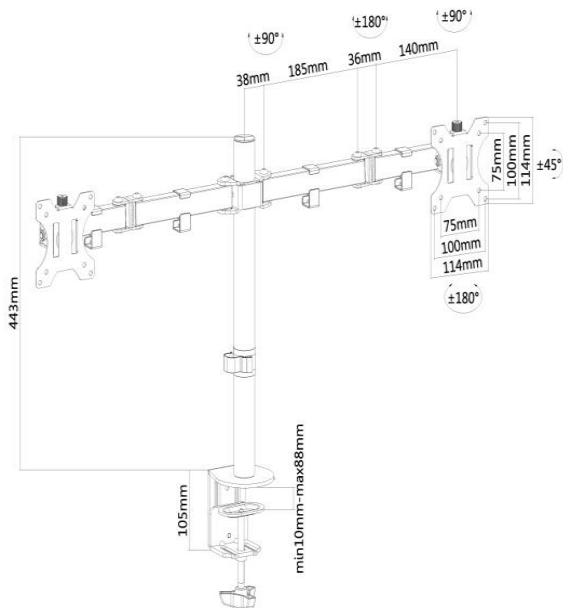
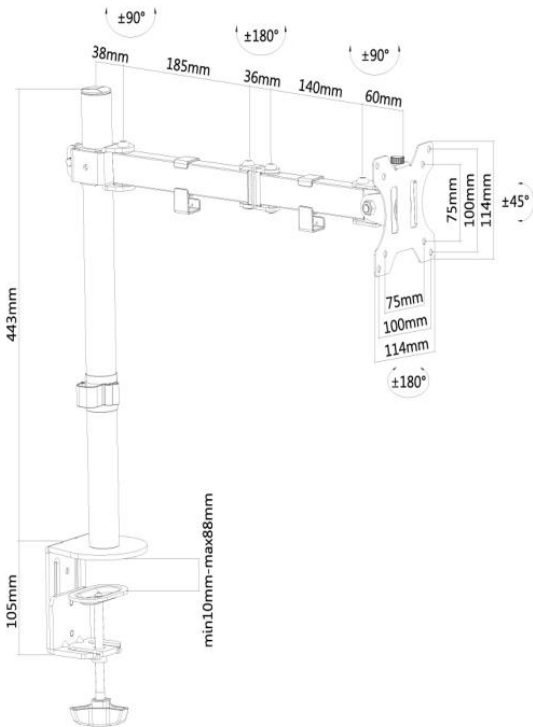

TECHNICAL FLATSCREEN MONITOR ARMS

CHARACTERISTICS

<p>TECHNICAL</p> 	<p>Materials: Steel - Polished aluminium - ABS</p> <p>Maximum load: Compatible with 95% of monitors (up to 7 kg per arm/screen)</p> <p>VESA bracket size: Standard - 100 mm x 100 mm and 75 mm x 75 mm. Easy to mount/dismount.</p> <p>Maximum recommended screen size: 27 inches</p> <p>Technical characteristics: Monitor arms with gas-spring mechanism</p> <p>Cable management: Integrated ABS cover to conceal cables</p> <p>Adjustments:</p> <ul style="list-style-type: none">- Range: 283 mm (one-part arm) or 433 mm (two-part arm)- Smooth, precise adjustments- Pivots 360°, with an adjustable stop at 180°- The pivot function allows the monitor to be used in portrait or landscape format <p>Fastening (for 1 or 2 screens):</p> <ul style="list-style-type: none">- "3-in-1" mount: clamp mount for worktops of thickness 10 to 50 mm (clamping depth 25 mm) or grommet mount (through a hole or cable port)- Clamp mount for worktops of thickness 13 to 35 mm (clamping depth 65 mm); compatible with SOLANGE desktop screens <p>Design:</p> <ul style="list-style-type: none">- Modular system: Sold as sets or individual items to facilitate changes in configuration: from 1 screen to 2 screens, or from a one-part arm to a two-part arm. <p>Cleaning: Clean surfaces using a non-abrasive liquid detergent and water. Wipe gently with a soft cloth to remove dirt and stains. Dry surfaces carefully using a soft dry cloth.</p>
--	---

One-part arm version

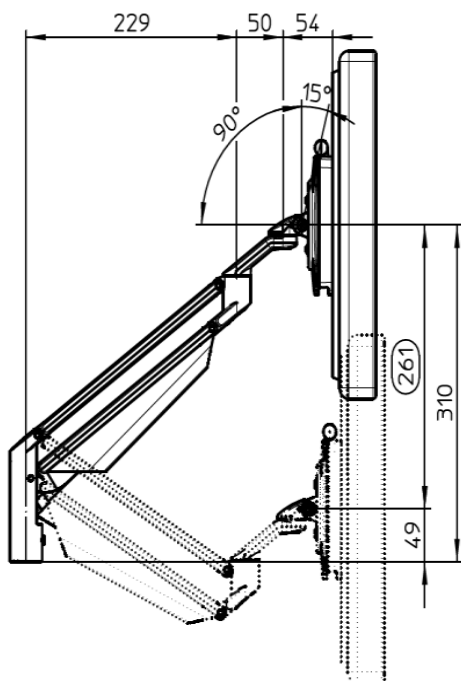
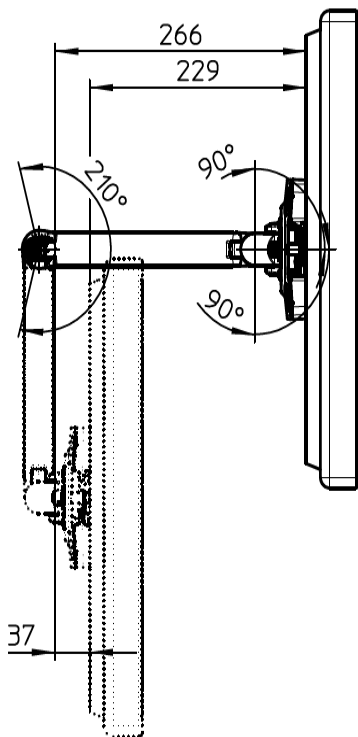
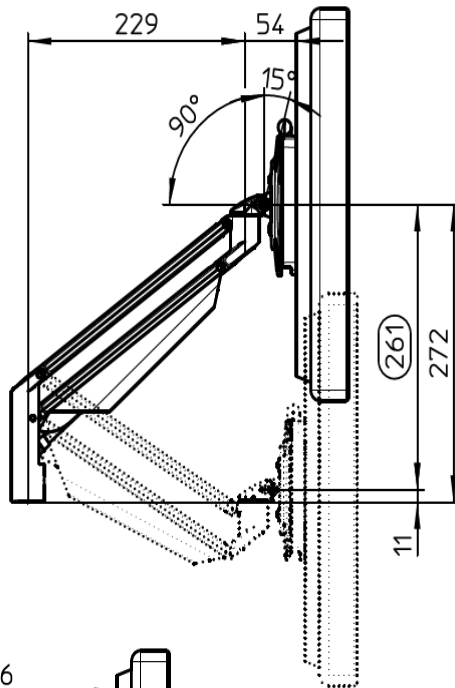

Two-part arm version

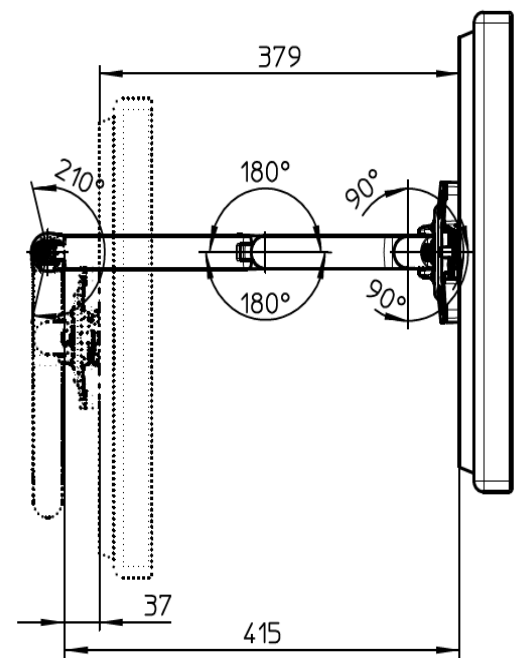
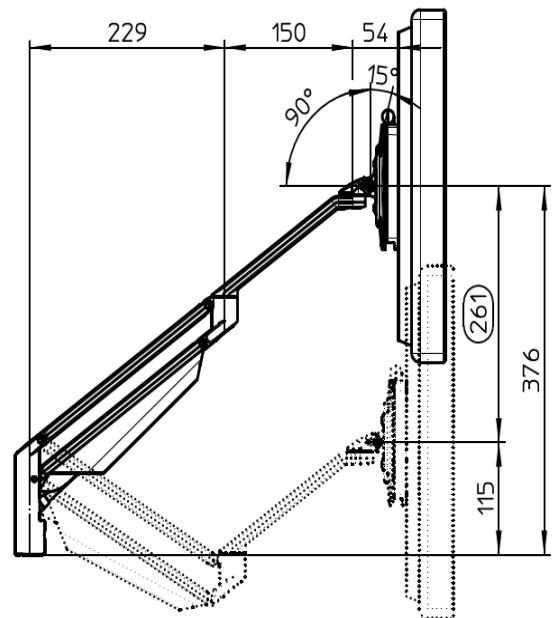

2-screen arm

